



// FEATURES

- Quick-Click installation: our Quick-Click system makes installation easy and avoids additional fixing holes.
- Drill-free: easy fitting and installation. SmartLocker AX is fully customizable. The platform offers the right variant for every cabinet door.
- Bolt inserts: quick and convenient adjustment. Different bolt inserts enable the lock to be optimally positioned in the locker door.
- No more deadbolt blocking: the pre-tensioned bolt spring prevents the bolt from blocking if the locker is too full and objects are pressing against the locker door on the inside.
- Anti-tampering contact on the housing lid: any tampering attempts can be displayed in the LSM software.
- Emergency power supply via USB: if the batteries should actually be flat, SmartLocker AX can simply be powered and opened via a USB port as a back-up power supply.
- Made in Germany. A given for us.

// TECHNICAL DATA

Opening diameter in locker/cabinet	19 mm (double D punch)	Battery life	Up to 50,000 lock operations or up to 5 years on standby (depending on reading technology and operating mode)
Operation types	<ul style="list-style-type: none"><li>Wireless Online (WO)</li><li>Offline: SimonsVoss Virtual Card Network (SVCN)</li><li>Offline: OSS Standard Offline (OSS SO)</li></ul>	Temperature range	0 °C to +65 °C
Reader systems	<ul style="list-style-type: none"><li>WO: MIFARE® Classic, MIFARE® DESFire® EV1/EV2/EV3, UID (card serial number) as per ISO 14443 (e.g. MIFARE®, Legic® Advant, HID® SEOS)</li><li>VCN: MIFARE® Classic, MIFARE® DESFire® EV1/EV2/EV3</li><li>OSS: MIFARE® DESFire® EV1/EV2/EV3</li></ul>	Feedback signal	<ul style="list-style-type: none"><li>Audible (buzzer),</li><li>Visual (LED – green/red)</li></ul>
Battery type	2 x AA round cell 1.5 V (alkaline)	IP classification	IP40
		Upgradeable via BLE	Firmware upgradeable
		Integrator-specific values: number of media, time profiles,...	Depends on system integrator
		Storable access events	Up to 1000
		Wireless network 868 MHz	Network-ready with integrated LockNode (WO)

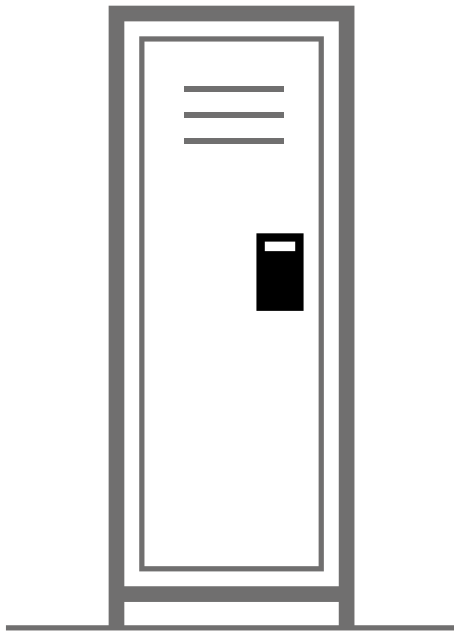

## // READER UNIT DIMENSIONS

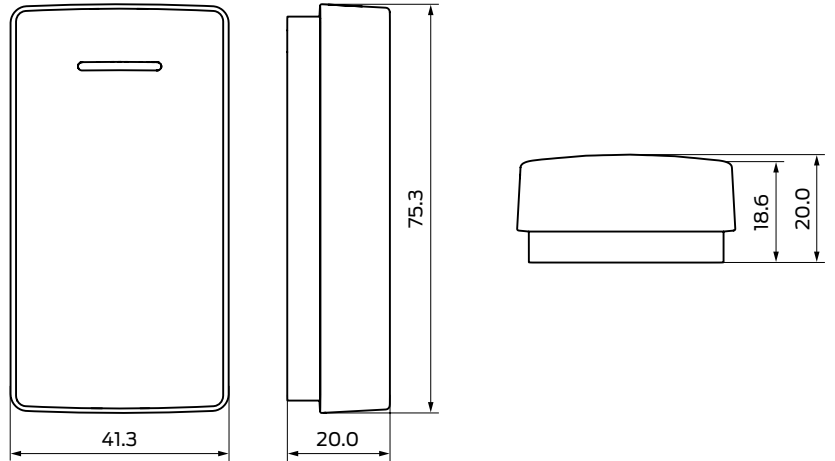

## // LOCKER LOCK DIMENSIONS

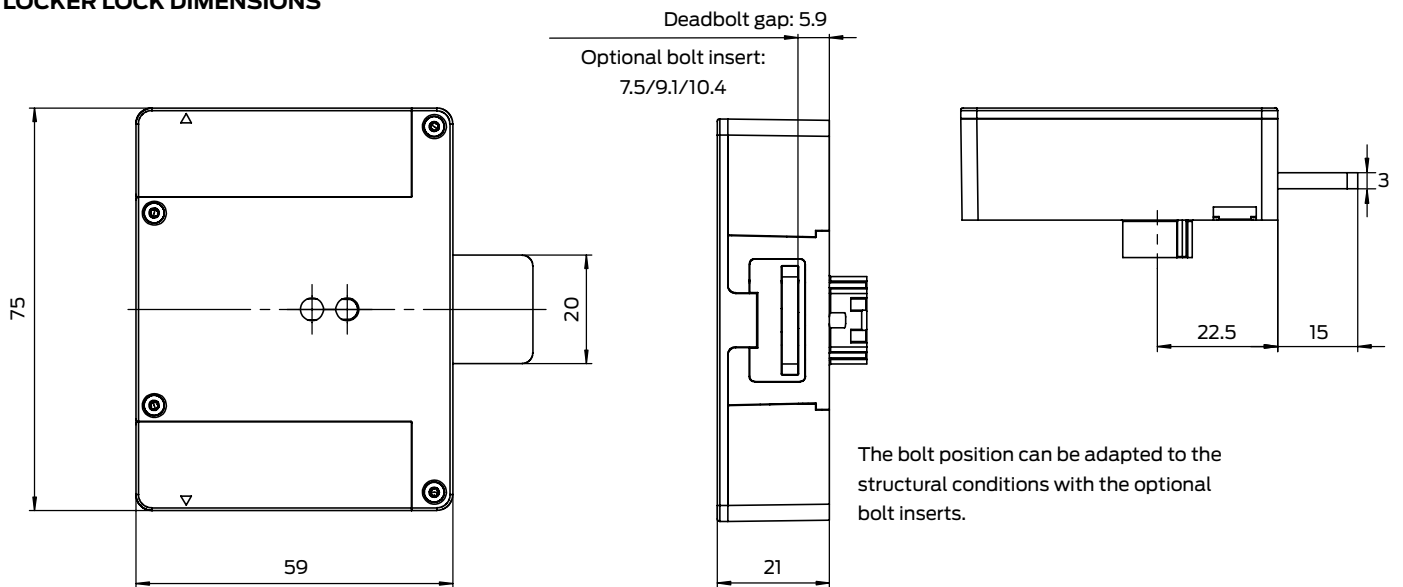

## // DIMENSIONS OF VARIABLE SPACER PLATE

Anti-twist protection to wedge against door rebate in metal doors

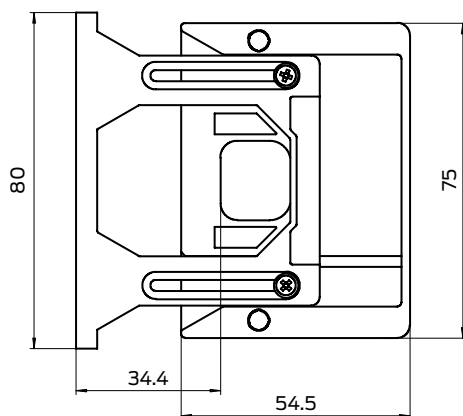

Maximum: 34.4 mm  
Minimal: 15 mm

## // DIMENSIONS OF SPACER PLATE

for adjusting the bolt position

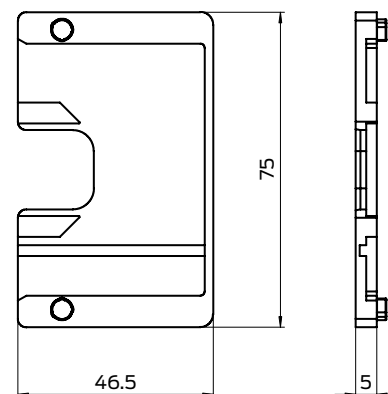

Measurements indicated in mm